

**MICRON**

## UltraTRUE™

### Helical True Planetary Gearheads

Ready for Immediate Delivery	
<b>Precision</b>	4 arc-minutes
<b>Frame Sizes</b>	60 mm, 75 mm, 90 mm, 100 mm, 115 mm, 140 mm, 180 mm and 220 mm
<b>Torque Capacity</b>	up to 3300 Nm
<b>Ratio Availability</b>	4:1 thru 100:1
<b>Radial load capacity</b>	up to 37910 N
<b>Mounting System</b>	RediMount™

- ① **Tapered roller bearings**  
provide high axial and radial load carrying capacity
- ② **Helical crowned**  
HRC 55-60 steel gears  
provide higher torque capacity and smoother operation
- ③ **Sealed deep groove ball bearing**  
provides high radial load carrying capability
- ④ **RediMount system**  
provides error-free motor installation
- ⑤ **Single-piece output**  
integrated output housing and internal gear
- ⑥ **Anodized aluminum housing**  
reduces weight and prevents corrosion

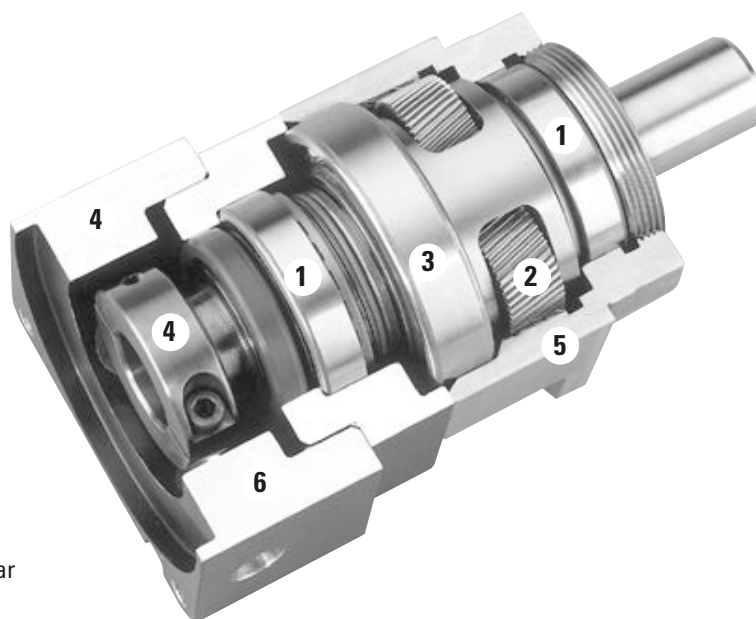

**Micron True™ Planetary Gearheads  
shipped within 24 hours!**



**Need it fast? Go to the back cover  
of the catalog for details.**



**MICRON**

# UltraTRUE™ Size 75

## Helical True Planetary Gearheads

Metric

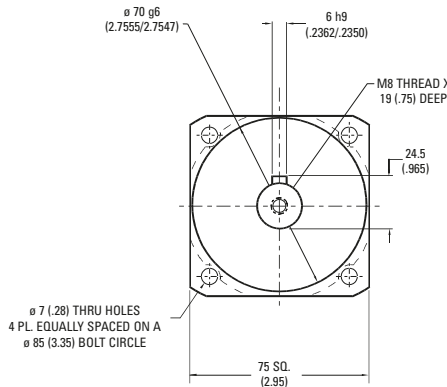
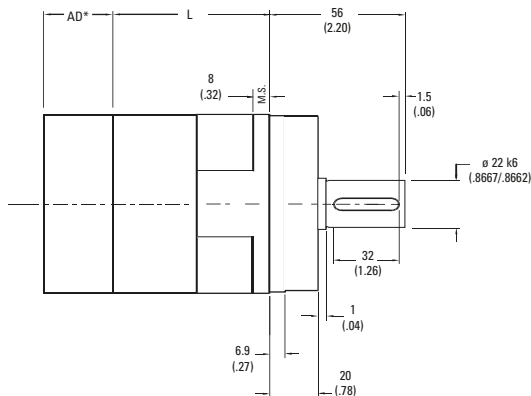

Ratio <sup>1</sup>	Dimension 'L' mm [in.]	Backlash [arc-min]	Weight kg [lb.]	Efficiency
4:1 to 10:1	60 [2.35]	4 max	2.5 [5.5]	95%
16:1 to 100:1	117 [4.60]	5 max	3.0 [6.6]	90%

All dimensions are: mm (in.)

AD\*\* = Adapter length

Adapter length will vary depending on motor.

M.S.= Mounting Surface

Efficiency is calculated at 100% of the rated torque.

## Performance Specifications

Part Number	Ratio <sup>1</sup>	10,000 Hour Life			T peak Nm [in.-lb.]	20,000 Hour Life			J kg-cm <sup>2</sup> [in.-lb.-sec <sup>2</sup> x10 <sup>-4</sup> ]	Torsional Stiffness Nm/arc-min [in.-lb./arc-min]
		T <sub>r</sub> (1000 rpm) Nm [in.-lb.]	T <sub>r</sub> (3000 rpm) Nm [in.-lb.]	T <sub>r</sub> (5000 rpm) Nm [in.-lb.]		T <sub>r</sub> (1000 rpm) Nm [in.-lb.]	T <sub>r</sub> (3000 rpm) Nm [in.-lb.]	T <sub>r</sub> (5000 rpm) Nm [in.-lb.]		
UT075-004	4:1	86 [762]	78 [689]	73 [649]	179 [1581]	84 [746]	74 [652]	63 [559]	,46 [ 4.1]	7,00 [61.9]
UT075-005	5:1	84 [740]	76 [672]	72 [636]	174 [1537]	82 [723]	74 [657]	66 [583]	,38 [ 3.4]	6,86 [60.7]
UT075-007	7:1	80 [706]	73 [646]	69 [615]	166 [1469]	78 [690]	71 [632]	68 [601]	,31 [ 2.8]	6,07 [53.7]
UT075-010	10:1	47 [418]	41 [360]	38 [335]	157 [1393]	44 [387]	38 [333]	35 [310]	,27 [ 2.4]	4,46 [39.5]
UT075-016	16:1	95 [838]	88 [780]	85 [749]	197 [1743]	93 [820]	86 [762]	83 [732]	,31 [ 2.8]	7,36 [65.1]
UT075-020	20:1	96 [849]	90 [792]	86 [762]	199 [1762]	94 [830]	88 [775]	84 [746]	,31 [ 2.8]	7,20 [63.7]
UT075-025	25:1	93 [820]	87 [767]	84 [740]	192 [1698]	91 [801]	85 [750]	82 [723]	,31 [ 2.8]	7,07 [62.6]
UT075-028	28:1	98 [864]	92 [811]	88 [782]	202 [1789]	96 [845]	90 [793]	86 [765]	,28 [ 2.5]	6,45 [57.1]
UT075-035	35:1	94 [834]	89 [784]	86 [758]	194 [1721]	92 [815]	87 [767]	84 [741]	,16 [ 1.4]	6,68 [59.1]
UT075-040	40:1	99 [880]	94 [829]	91 [802]	205 [1813]	97 [861]	92 [811]	89 [785]	,16 [ 1.4]	7,37 [65.2]
UT075-050	50:1	96 [849]	91 [801]	88 [777]	197 [1743]	94 [830]	89 [784]	86 [759]	,16 [ 1.4]	7,22 [63.9]
UT075-070	70:1	91 [802]	86 [760]	83 [738]	185 [1639]	89 [784]	84 [743]	82 [722]	,16 [ 1.4]	6,48 [57.3]
UT075-100	100:1	63 [554]	55 [486]	52 [456]	173 [1529]	58 [513]	51 [450]	48 [422]	,15 [ 1.3]	4,50 [39.8]

All ratios are available to ship in 24 hours through the Gearhead Express Program.

<sup>1</sup> Ratios are exact, higher ratios are also available, consult factory.  
T<sub>r</sub> = Rated output torque at rated speed for specific hours of life.

T<sub>peak</sub> = Allowable momentary peak torque for emergency stop or heavy shock loading.  
J = Mass moment of inertia reflected to the input shaft (including pinion assembly).

TRUE™ Planetary Gearheads

# UltraTRUE Size 90

## Helical True Planetary Gearheads

Metric

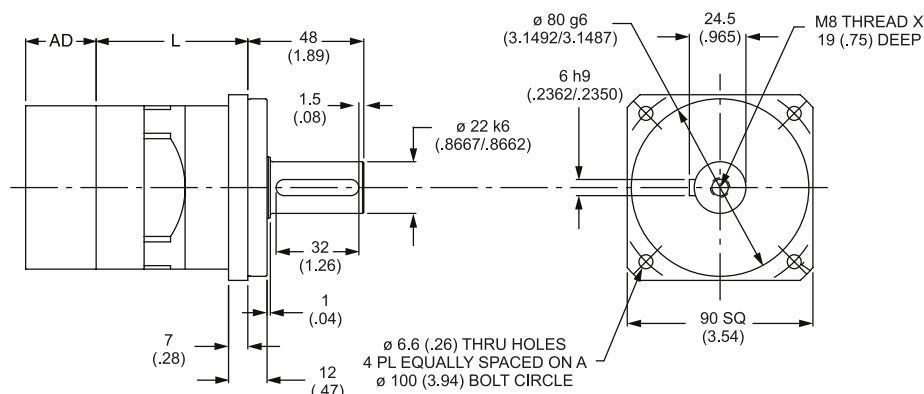

Ratio <sup>1</sup>	Dimension 'L' mm [in.]	Backlash [arc-min]	Weight kg [lb.]	Efficiency
4:1 to 10:1	68 [2.66]	4 max	2,5 [5.5]	95%
16:1 to 100:1	125 [4.91]	5 max	3,0 [6.6]	90%

All dimensions are: mm (in.)  
 AD\*\* = Adapter length  
 Adapter length and width will vary depending on motor.  
 M.S.= Mounting Surface  
 Efficiency is calculated at 100% of the rated torque.

## Performance Specifications

Part Number	Ratio <sup>1</sup>	10,000 Hour Life			T <sub>peak</sub> Nm [in.-lb.]	20,000 Hour Life			J kg-cm <sup>2</sup> [in.-lb.-sec <sup>2</sup> x10 <sup>-4</sup> ]	Torsional Stiffness Nm/arc-min [in.-lb./arc-min]
		T <sub>r</sub> (1000 rpm) Nm [in.-lb.]	T <sub>r</sub> (3000 rpm) Nm [in.-lb.]	T <sub>r</sub> (5000 rpm) Nm [in.-lb.]		T <sub>r</sub> (1000 rpm) Nm [in.-lb.]	T <sub>r</sub> (3000 rpm) Nm [in.-lb.]	T <sub>r</sub> (5000 rpm) Nm [in.-lb.]		
UT090-004	4:1	86 [762]	78 [689]	73 [649]	179 [1581]	84 [746]	74 [652]	63 [559]	,46 [4.1]	7,00 [61.9]
UT090-005	5:1	84 [740]	76 [672]	72 [636]	174 [1537]	82 [723]	74 [657]	66 [583]	,38 [3.4]	6,86 [60.7]
UT090-007	7:1	80 [706]	73 [646]	69 [615]	166 [1469]	78 [690]	71 [632]	68 [601]	,31 [2.8]	6,07 [53.7]
UT090-010	10:1	47 [418]	41 [360]	38 [335]	157 [1393]	44 [387]	38 [333]	35 [310]	,27 [2.4]	4,46 [39.5]
UT090-016	16:1	95 [838]	88 [780]	85 [749]	197 [1743]	93 [820]	86 [762]	83 [732]	,31 [2.8]	7,36 [65.1]
UT090-020	20:1	96 [849]	90 [792]	86 [762]	199 [1762]	94 [830]	88 [775]	84 [746]	,31 [2.8]	7,20 [63.7]
UT090-025	25:1	93 [820]	87 [767]	84 [740]	192 [1698]	91 [801]	85 [750]	82 [723]	,31 [2.8]	7,07 [62.6]
UT090-028	28:1	98 [864]	92 [811]	88 [782]	202 [1789]	96 [845]	90 [793]	86 [765]	,28 [2.5]	6,45 [57.1]
UT090-035	35:1	94 [834]	89 [784]	86 [758]	194 [1721]	92 [815]	87 [767]	84 [741]	,16 [1.4]	6,68 [59.1]
UT090-040	40:1	99 [880]	94 [829]	91 [802]	205 [1813]	97 [861]	92 [811]	89 [785]	,16 [1.4]	7,37 [65.2]
UT090-050	50:1	96 [849]	91 [801]	88 [777]	197 [1743]	94 [830]	89 [784]	86 [759]	,16 [1.4]	7,22 [63.9]
UT090-070	70:1	91 [802]	86 [760]	83 [738]	185 [1639]	89 [784]	84 [743]	82 [722]	,16 [1.4]	6,48 [57.3]
UT090-100	100:1	63 [554]	55 [486]	52 [456]	173 [1529]	58 [513]	51 [450]	48 [422]	,15 [1.3]	4,50 [39.8]

<sup>1</sup> Ratios are exact, higher ratios are also available, consult factory.  
 T<sub>r</sub> = Rated output torque at rated speed for specific hours of life.

T<sub>peak</sub> = Allowable momentary peak torque for emergency stop or heavy shock loading.  
 J = Mass moment of inertia reflected to the input shaft (including pinion assembly).

**MICRON**

# UltraTRUE™ Size 10

## Helical True Planetary Gearheads

Metric

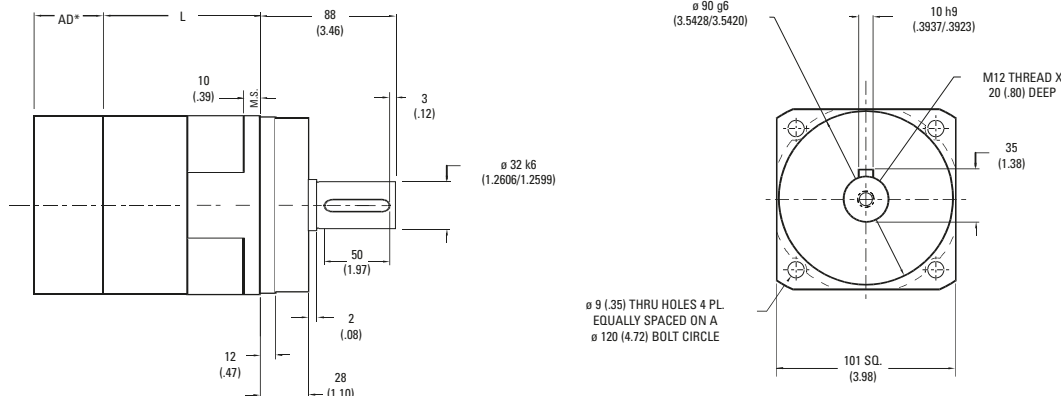

Ratio <sup>1</sup>	Dimension 'L' mm [in.]	Backlash [arc-min]	Weight kg [lb.]	Efficiency
4:1 to 10:1	78 [3.07]	4 max	6 [13]	95%
16:1 to 100:1	146 [5.75]	5 max	8 [18]	90%

All dimensions are: mm (in.)  
 AD\*\* = Adapter length  
 Adapter length and width will vary depending on motor.  
 M.S.= Mounting Surface  
 Efficiency is calculated at 100% of the rated torque.

## Performance Specifications

Part Number	Ratio <sup>1</sup>	10,000 Hour Life			T peak Nm [in.-lb.]	20,000 Hour Life			J kg-cm <sup>2</sup> [in.-lb.-sec <sup>2</sup> ×10 <sup>-4</sup> ]	Torsional Stiffness Nm/arc-min [in.-lb./arc-min]
		T <sub>r</sub> (1000 rpm) Nm [in.-lb.]	T <sub>r</sub> (3000 rpm) Nm [in.-lb.]	T <sub>r</sub> (5000 rpm) Nm [in.-lb.]		T <sub>r</sub> (1000 rpm) Nm [in.-lb.]	T <sub>r</sub> (3000 rpm) Nm [in.-lb.]	T <sub>r</sub> (5000 rpm) Nm [in.-lb.]		
UT010-004	4:1	252 [2229]	217 [1922]	186 [1649]	514 [4548]	245 [2171]	176 [1561]	151 [1340]	1,58 [14.0]	25,7 [227]
UT010-005	5:1	245 [2168]	220 [1950]	194 [1720]	501 [4434]	240 [2120]	184 [1628]	158 [1397]	1,36 [12.0]	22,8 [202]
UT010-007	7:1	234 [2074]	213 [1882]	201 [1780]	481 [4256]	229 [2028]	196 [1736]	168 [1489]	,97 [ 8.6]	21,1 [187]
UT010-010	10:1	138 [1220]	118 [1048]	110 [971]	457 [4044]	128 [1129]	110 [969]	102 [898]	,90 [ 8.0]	14,4 [128]
UT010-016	16:1	279 [2471]	258 [2284]	247 [2184]	575 [5085]	273 [2416]	252 [2233]	229 [2030]	1,10 [9.7]	27,3 [242]
UT010-020	20:1	283 [2505]	263 [2325]	252 [2229]	582 [5152]	277 [2450]	257 [2273]	245 [2171]	1,10 [9.7]	24,3 [215]
UT010-025	25:1	274 [2422]	255 [2256]	245 [2168]	562 [4974]	268 [2368]	249 [2206]	240 [2120]	1,10 [9.7]	24,3 [215]
UT010-028	28:1	289 [2554]	269 [2384]	259 [2293]	592 [5242]	282 [2498]	263 [2331]	253 [2242]	,94 [8.3]	21,1 [187]
UT010-035	35:1	279 [2468]	261 [2310]	252 [2227]	571 [5054]	273 [2413]	255 [2259]	246 [2177]	,79 [7.0]	20,9 [185]
UT010-040	40:1	294 [2604]	276 [2442]	266 [2357]	602 [5327]	288 [2546]	270 [2388]	260 [2305]	,79 [7.0]	27,4 [243]
UT010-050	50:1	284 [2514]	267 [2364]	258 [2286]	579 [5128]	278 [2458]	261 [2312]	253 [2235]	,78 [6.9]	24,1 [213]
UT010-070	70:1	269 [2380]	254 [2246]	246 [2177]	546 [4832]	263 [2327]	248 [2197]	241 [2129]	,78 [6.9]	21,1 [187]
UT010-100	100:1	184 [1626]	161 [1423]	151 [1335]	510 [4510]	170 [1504]	149 [1317]	140 [1235]	,78 [6.9]	17,2 [152]

All ratios are available to ship in 24 hours through the Gearhead Express Program.

<sup>1</sup> Ratios are exact, higher ratios are also available, consult factory.  
 T<sub>r</sub> = Rated output torque at rated speed for specific hours of life.

T<sub>peak</sub> = Allowable momentary peak torque for emergency stop or heavy shock loading.  
 J = Mass moment of inertia reflected to the input shaft (including pinion assembly).

TRUE™ Planetary Gearheads

# UltraTRUE Size 115

## Helical True Planetary Gearheads

Metric

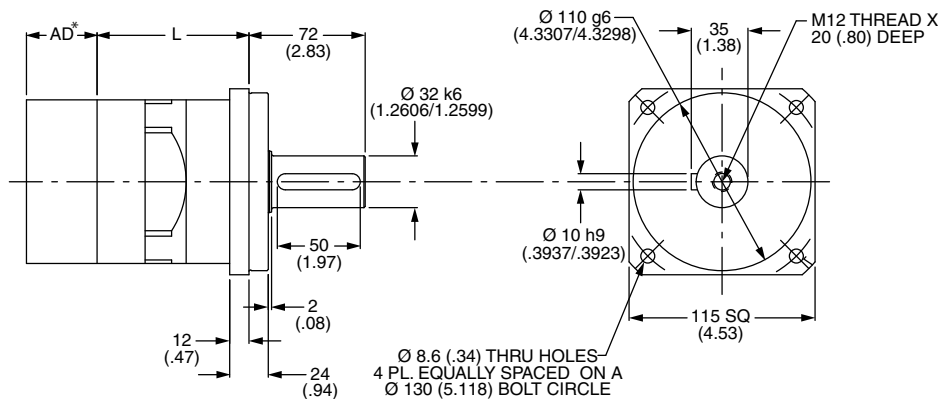

Ratio <sup>1</sup>	Dimension 'L' mm [in.]	Backlash [arc-min]	Weight kg [lb.]	Efficiency
4:1 to 10:1	94 [3.70]	4 max	6 [13]	95%
16:1 to 100:1	162 [6.38]	5 max	6 [18]	88%

All dimensions are: mm (in.)  
 AD\*\* = Adapter length  
 Adapter length and width will vary depending on motor.  
 M.S. = Mounting Surface  
 Efficiency is calculated at 100% of the rated torque.

### Performance Specifications

Part Number	Ratio <sup>1</sup>	10,000 Hour Life				T <sub>peak</sub> Nm [in.-lb.]	20,000 Hour Life			J kg-cm <sup>2</sup> [in.-lb.-sec <sup>2</sup> ×10 <sup>-4</sup> ]	Torsional Stiffness Nm/arc-min [in.-lb./arc-min]
		T <sub>r</sub> (1000 rpm) Nm [in.-lb.]	T <sub>r</sub> (3000 rpm) Nm [in.-lb.]	T <sub>r</sub> (5000 rpm) Nm [in.-lb.]	T <sub>r</sub> (1000 rpm) Nm [in.-lb.]		T <sub>r</sub> (3000 rpm) Nm [in.-lb.]	T <sub>r</sub> (5000 rpm) Nm [in.-lb.]			
UT115-004	4:1	252 [2229]	217 [1922]	186 [1649]	514 [4548]	245 [2171]	176 [1561]	151 [1340]	1,58 [14.0]	25,7 [227]	
UT115-005	5:1	245 [2168]	220 [1950]	194 [1720]	501 [4434]	240 [2120]	184 [1628]	158 [1397]	1,36 [12.0]	22,8 [202]	
UT115-007	7:1	234 [2074]	213 [1882]	201 [1780]	481 [4256]	229 [2028]	196 [1736]	168 [1489]	,97 [ 8.6]	21,1 [187]	
UT115-010	10:1	138 [1220]	118 [1048]	110 [971]	457 [4044]	128 [1129]	110 [969]	102 [898]	,90 [ 8.0]	14,4 [128]	
UT115-016	16:1	279 [2471]	258 [2284]	247 [2184]	575 [5085]	273 [2416]	252 [2233]	229 [2030]	1,10 [9.7]	27,3 [242]	
UT115-020	20:1	283 [2505]	263 [2325]	252 [2229]	582 [5152]	277 [2450]	257 [2273]	245 [2171]	1,10 [9.7]	24,3 [215]	
UT115-025	25:1	274 [2422]	255 [2256]	245 [2168]	562 [4974]	268 [2368]	249 [2206]	240 [2120]	1,10 [9.7]	24,3 [215]	
UT115-028	28:1	289 [2554]	269 [2384]	259 [2293]	592 [5242]	282 [2498]	263 [2331]	253 [2242]	,94 [8.3]	21,1 [187]	
UT115-035	35:1	279 [2468]	261 [2310]	252 [2227]	571 [5054]	273 [2413]	255 [2259]	246 [2177]	,79 [7.0]	20,9 [185]	
UT115-040	40:1	294 [2604]	276 [2442]	266 [2357]	602 [5327]	288 [2546]	270 [2388]	260 [2305]	,79 [7.0]	27,4 [243]	
UT115-050	50:1	284 [2514]	267 [2364]	258 [2286]	579 [5128]	278 [2458]	261 [2312]	253 [2235]	,78 [6.9]	24,1 [213]	
UT115-070	70:1	269 [2380]	254 [2246]	246 [2177]	546 [4832]	263 [2327]	248 [2197]	241 [2129]	,78 [6.9]	21,1 [187]	
UT115-100	100:1	184 [1626]	161 [1423]	151 [1335]	510 [4510]	170 [1504]	149 [1317]	140 [1235]	,78 [6.9]	17,2 [152]	

<sup>1</sup> Ratios are exact, higher ratios are also available, consult factory.  
 T<sub>r</sub> = Rated output torque at rated speed for specific hours of life.

T<sub>peak</sub> = Allowable momentary peak torque for emergency stop or heavy shock loading.  
 J = Mass moment of inertia reflected to the input shaft (including pinion assembly).

**MICRON**

# UltraTRUE™ Size 14

## Helical True Planetary Gearheads

Metric

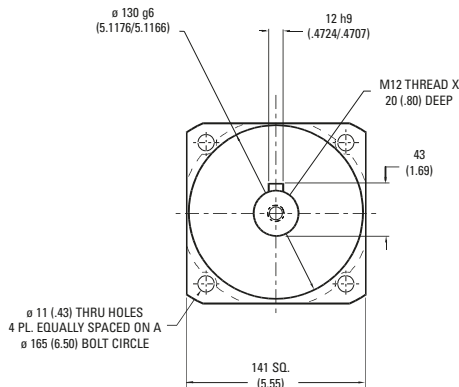
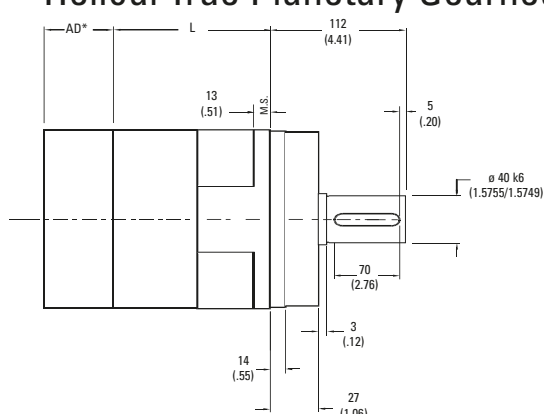

Ratio <sup>1</sup>	Dimension 'L' mm [in.]	Backlash [arc-min]	Weight kg [lb.]	Efficiency
4:1 to 10:1	110,5 [4.35]	4 max	14 [31]	95%
16:1 to 100:1	195 [7.69]	5 max	18 [40]	90%

All dimensions are: mm (in.)  
 AD\*\* = Adapter length  
 Adapter length and width will vary depending on motor.  
 M.S.= Mounting Surface  
 Efficiency is calculated at 100% of the rated torque.

## Performance Specifications

Part Number	Ratio <sup>1</sup>	10,000 Hour Life			T <sub>peak</sub> Nm [in.-lb.]	20,000 Hour Life			J kg-cm <sup>2</sup> [in.-lb.-sec <sup>2</sup> x10 <sup>-4</sup> ]	Torsional Stiffness Nm/arc-min [in.-lb./arc-min]
		T <sub>r</sub> (1000 rpm) Nm [in.-lb.]	T <sub>r</sub> (3000 rpm) Nm [in.-lb.]	T <sub>r</sub> (5000 rpm) Nm [in.-lb.]		T <sub>r</sub> (1000 rpm) Nm [in.-lb.]	T <sub>r</sub> (3000 rpm) Nm [in.-lb.]	T <sub>r</sub> (5000 rpm) Nm [in.-lb.]		
UT014-004	4:1	588 [5207]	521 [4613]	454 [4022]	1184 [10,479]	575 [5092]	430 [3808]	369 [3267]	6,51 [57.6]	55 [487]
UT014-005	5:1	572 [5066]	511 [4519]	474 [4191]	1156 [10,229]	560 [4954]	448 [3968]	385 [3404]	5,02 [44.4]	51 [452]
UT014-007	7:1	549 [4857]	494 [4375]	466 [4120]	1113 [9851]	537 [4749]	478 [4232]	410 [3631]	3,80 [33.6]	47 [420]
UT014-010	10:1	329 [2913]	282 [2492]	260 [2304]	1062 [9399]	305 [2696]	261 [2306]	241 [2132]	3,39 [30.0]	35 [311]
UT014-016	16:1	657 [5817]	604 [5346]	576 [5095]	1340 [11,860]	643 [5688]	591 [5227]	559 [4951]	4,21 [37.2]	58 [514]
UT014-020	20:1	667 [5902]	616 [5449]	588 [5207]	1360 [12,035]	652 [5772]	602 [5328]	575 [5092]	4,07 [36.0]	54 [479]
UT014-025	25:1	645 [5706]	598 [5288]	572 [5066]	1314 [11,625]	630 [5579]	584 [5171]	560 [4954]	4,07 [36.0]	54 [479]
UT014-028	28:1	681 [6026]	632 [5597]	607 [5369]	1387 [12,274]	666 [5892]	618 [5473]	593 [5250]	3,53 [31.2]	47 [417]
UT014-035	35:1	658 [5820]	613 [5424]	589 [5215]	1338 [11,837]	643 [5691]	599 [5304]	576 [5099]	2,99 [26.4]	44 [391]
UT014-040	40:1	695 [6150]	649 [5745]	625 [5530]	1412 [12,498]	680 [6014]	635 [5617]	611 [5408]	2,99 [26.4]	58 [512]
UT014-050	50:1	671 [5935]	628 [5560]	606 [5363]	1360 [12,034]	656 [5803]	614 [5437]	593 [5244]	2,85 [25.2]	54 [479]
UT014-070	70:1	635 [5623]	598 [5291]	578 [5118]	1283 [11,359]	621 [5499]	585 [5174]	565 [5004]	2,85 [25.2]	49 [435]
UT014-100	100:1	441 [3898]	385 [3407]	361 [3193]	1201 [10,627]	408 [3607]	356 [3153]	334 [2954]	2,85 [25.2]	35 [312]

All ratios are available to ship in 24 hours through the Gearhead Express Program.

<sup>1</sup> Ratios are exact, higher ratios are also available, consult factory.  
 T<sub>r</sub> = Rated output torque at rated speed for specific hours of life.

T<sub>peak</sub> = Allowable momentary peak torque for emergency stop or heavy shock loading.  
 J = Mass moment of inertia reflected to the input shaft (including pinion assembly).



TRUE™ Planetary Gearheads

UltraTRUE Size 18  
Helical True Planetary Gearheads

Metric

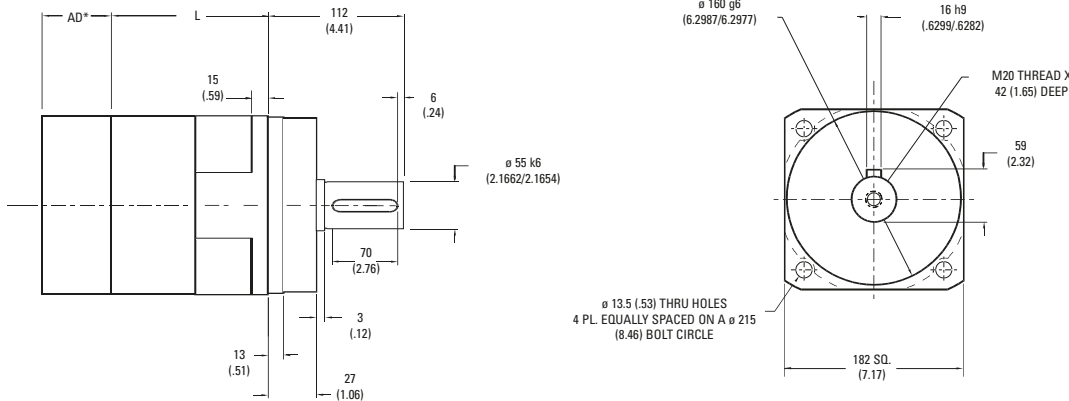

Ratio <sup>1</sup>	Dimension 'L' in. [mm]	Backlash [arc-min]	Weight kg [lb.]	Efficiency
4:1 to 10:1	136 [5.35]	4 max	40 [88]	95%
16:1 to 100:1	242 [9.54]	5 max	45 [99]	90%

All dimensions are: mm (in.)  
AD\*\* = Adapter length  
Adapter length and width will vary depending on motor.  
M.S. = Mounting Surface  
Efficiency is calculated at 100% of the rated torque.

Performance Specifications

Part Number	Ratio <sup>1</sup>	10,000 Hour Life			T peak Nm [in.-lb.]	20,000 Hour Life			J kg-cm <sup>2</sup> [in.-lb.-sec <sup>2</sup> x10 <sup>-4</sup> ]	Torsional Stiffness Nm/arc-min [in.-lb./arc-min]
		T <sub>r</sub> (1000 rpm) Nm [in.-lb.]	T <sub>r</sub> (3000 rpm) Nm [in.-lb.]	T <sub>r</sub> (5000 rpm) Nm [in.-lb.]		T <sub>r</sub> (1000 rpm) Nm [in.-lb.]	T <sub>r</sub> (3000 rpm) Nm [in.-lb.]	T <sub>r</sub> (5000 rpm) Nm [in.-lb.]		
UT018-004	4:1	1368 [12108]	1184 [10476]	1016 [8988]	2713 [24010]	1337 [11832]	962 [8509]	825 [7300]	25,9 [229]	153 [1358]
UT018-005	5:1	1333 [11800]	1179 [10430]	1058 [9366]	2654 [23492]	1304 [11539]	1002 [8868]	860 [7608]	20,0 [177]	150 [1330]
UT018-007	7:1	1281 [11338]	1144 [10128]	1073 [9494]	2565 [22699]	1253 [11087]	1069 [9458]	917 [8114]	14,6 [129]	134 [1185]
UT018-010	10:1	775 [6856]	660 [5841]	609 [5387]	2456 [21734]	717 [6344]	611 [5404]	563 [4984]	13,0 [115]	101 [893]
UT018-016	16:1	1541 [13641]	1408 [12457]	1336 [11827]	3111 [27532]	1507 [13339]	1376 [12181]	1250 [11065]	16,1 [142]	161 [1429]
UT018-020	20:1	1566 [13855]	1437 [12716]	1368 [12108]	3162 [27986]	1531 [13549]	1405 [12434]	1337 [11832]	15,6 [138]	156 [1382]
UT018-025	25:1	1515 [13407]	1396 [12359]	1333 [11800]	3060 [27078]	1481 [13110]	1366 [12085]	1304 [11539]	15,6 [138]	131 [1160]
UT018-028	28:1	1600 [14164]	1479 [13088]	1414 [12515]	3233 [28612]	1565 [13851]	1446 [12798]	1383 [12237]	13,5 [119]	138 [1225]
UT018-035	35:1	1547 [13691]	1435 [12701]	1376 [12174]	3122 [27633]	1513 [13388]	1403 [12420]	1345 [11904]	11,4 [101]	124 [1098]
UT018-040	40:1	1636 [14475]	1521 [13460]	1460 [12920]	3300 [29201]	1599 [14154]	1487 [13162]	1428 [12634]	11,4 [101]	161 [1429]
UT018-050	50:1	1579 [13978]	1474 [13042]	1418 [12547]	3181 [28153]	1544 [13668]	1441 [12754]	1386 [12269]	10,9 [96]	156 [1382]
UT018-070	70:1	1498 [13256]	1404 [12429]	1355 [11993]	3008 [26621]	1465 [12963]	1373 [12154]	1325 [11728]	10,9 [96]	138 [1225]
UT018-100	100:1	1042 [9218]	909 [8043]	851 [7528]	2819 [24949]	964 [8529]	841 [7442]	787 [6966]	10,9 [96]	103 [908]



**MICRON**

# UltraTRUE™ Size 22

## Helical True Planetary Gearheads

Metric

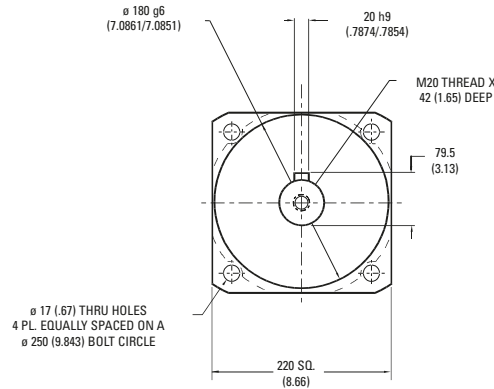
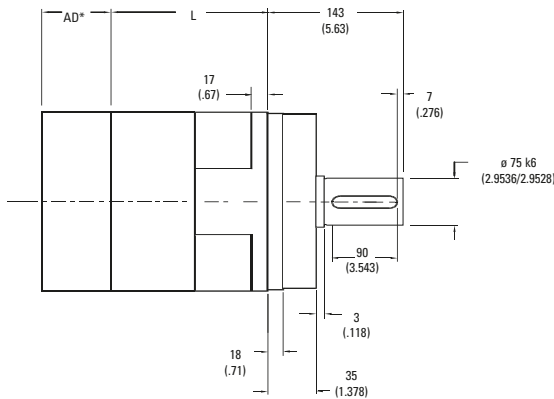

Ratio <sup>1</sup>	Dimension 'L' mm [in.]	Backlash [arc-min]	Weight kg [lb.]	Efficiency
4:1 to 10:1	142.6 [5.15]	4 max	74 [162]	93%
16:1 to 100:1	243.6 [9.60]	5 max	95 [209]	88%

All dimensions are: mm (in.)  
 AD\*\* = Adapter length  
 Adapter length will vary depending on motor.  
 M.S. = Mounting Surface  
 Efficiency is calculated at 100% of the rated torque.

### Performance Specifications

Part Number	Ratio <sup>1</sup>	10,000 Hour Life			T peak Nm [in.-lb.]	20,000 Hour Life			J kg-cm <sup>2</sup> [in.-lb.-sec <sup>2</sup> x10 <sup>-4</sup> ]	Torsional Stiffness Nm/arc-min [in.-lb./arc-min]
		T <sub>r</sub> (1000 rpm) Nm [in.-lb.]	T <sub>r</sub> (3000 rpm) Nm [in.-lb.]	T <sub>r</sub> (5000 rpm) Nm [in.-lb.]		T <sub>r</sub> (1000 rpm) Nm [in.-lb.]	T <sub>r</sub> (3000 rpm) Nm [in.-lb.]	T <sub>r</sub> (5000 rpm) Nm [in.-lb.]		
UT022-004	4:1	2256 [19694]	1786 [15806]	1532 [13560]	4644 [41096]	2017 [17850]	1451 [12838]	1245 [11014]	87,0 [7.70]	429 [3793]
UT022-005	5:1	2181 [19300]	1862 [16475]	1596 [14125]	4548 [40250]	2102 [18600]	1511 [13375]	1297 [11475]	73,4 [6.50]	414 [3661]
UT022-007	7:1	2090 [18496]	1857 [16432]	1703 [15073]	4370 [38671]	2042 [18075]	1613 [14271]	1383 [12243]	62,6 [5.55]	363 [3212]
UT022-010	10:1	1263 [11178]	1072 [9488]	987 [8737]	4301 [38060]	1167 [10325]	992 [8779]	914 [8085]	56,9 [5.04]	253 [2235]
UT022-016	16:1	2521 [20292]	2293 [20292]	2170 [19202]	5247 [46437]	2464 [21805]	2199 [19459]	1886 [16694]	87,3 [7.73]	436 [3858]
UT022-020	20:1	2561 [20732]	2343 [20732]	2224 [19683]	5323 [47107]	2504 [22164]	2291 [20273]	2017 [17850]	73,6 [6.52]	436 [3856]
UT022-025	25:1	2484 [20205]	2283 [20205]	2174 [19239]	5151 [45583]	2427 [21480]	2232 [19757]	2102 [18605]	73,1 [6.47]	418 [3699]
UT022-028	28:1	2620 [21365]	2414 [21365]	2302 [20375]	5427 [48027]	2560 [22660]	2361 [20892]	2231 [19476]	62,7 [5.55]	435 [3854]
UT022-035	35:1	2541 [20788]	2349 [20788]	2246 [19878]	5243 [46397]	2481 [21961]	2297 [20327]	2196 [19438]	62,5 [5.53]	418 [3698]
UT022-040	40:1	2680 [21998]	2486 [21998]	2381 [21069]	5524 [48888]	2619 [23182]	2431 [21510]	2328 [20602]	57,2 [5.06]	435 [3851]
UT022-050	50:1	2595 [21371]	2415 [21371]	2318 [20516]	5328 [47156]	2536 [22443]	2361 [20898]	2267 [20062]	57,1 [5.05]	418 [3696]
UT022-070	70:1	2461 [20373]	2302 [20373]	2217 [19623]	5025 [44470]	2405 [21288]	2251 [19922]	2168 [19189]	57,0 [5.04]	366 [3226]
UT022-100	100:1	1666 [13121]	1483 [13121]	1387 [12273]	4852 [42941]	1571 [13902]	1369 [12116]	1283 [11356]	56,9 [5.04]	253 [2238]

<sup>1</sup> Ratios are exact, higher ratios are also available, consult factory.  
 T<sub>r</sub> = Rated output torque at rated speed for specific hours of life.

T<sub>peak</sub> = Allowable momentary peak torque for emergency stop or heavy shock loading.  
 J = Mass moment of inertia reflected to the input shaft (including pinion assembly).

TRUE™ Planetary Gearheads

# Radial and Axial Load Ratings

## UT006

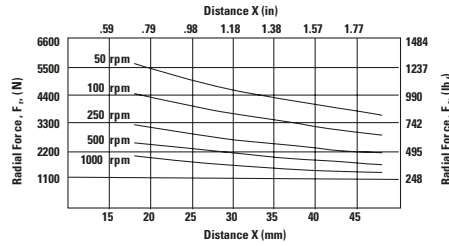
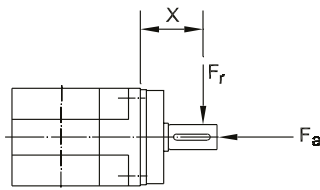

Speed rpm	Axial Load, $F_a$ N [lb.]
50	7198 [1618]
100	5710 [1284]
250	4208 [946]
500	3342 [751]
1000	2652 [596]

## UT075

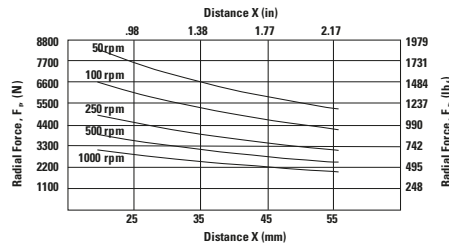
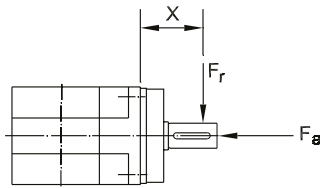

Speed rpm	Axial Load, $F_a$ N [lb.]
50	9903 [2227]
100	7863 [1768]
250	5793 [1303]
500	4599 [1034]
1000	3650 [821]

## UT090

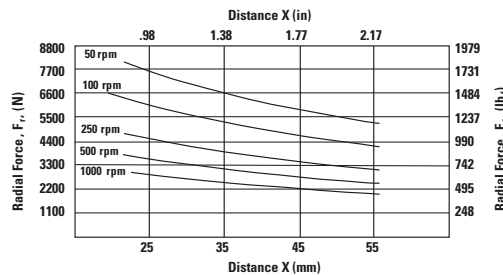
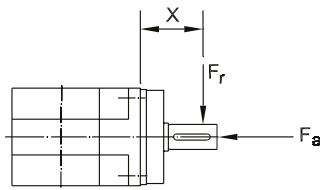

Speed rpm	Axial Load, $F_a$ N [lb.]
50	9903 [2227]
100	7863 [1768]
250	5793 [1303]
500	4599 [1034]
1000	3650 [821]

## UT010

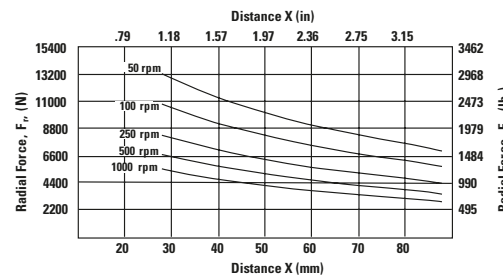
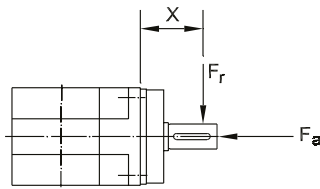

Speed rpm	Axial Load, $F_a$ N [lb.]
50	13,675 [3075]
100	11,107 [2497]
250	8435 [1897]
500	6855 [1542]
1000	5568 [1252]

These graphs display the allowable radial load at a given distance (X) from the mounting surface based on an  $L_{10}$  life of 10,000 hours for the mean output speed  $n_{mout}$ , as described on page 9.

**MICRON**

## Radial and Axial Load Ratings

### UT115

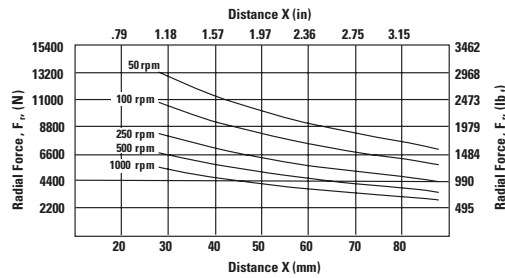
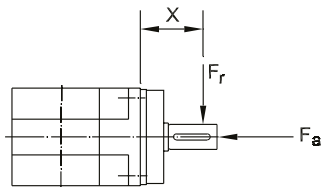

Speed rpm	Axial Load, $F_a$ N [lb <sub>f</sub> ]
50	13,675 [3075]
100	11,107 [2497]
250	8435 [1897]
500	6855 [1542]
1000	5568 [1252]

### UT014

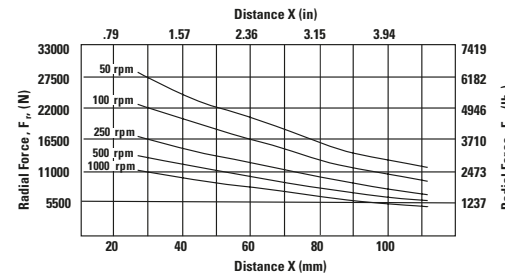
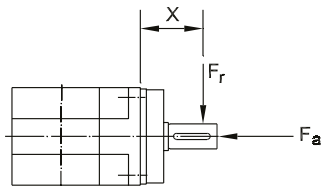

Speed rpm	Axial Load, $F_a$ N [lb <sub>f</sub> ]
50	25,374 [5705]
100	20,609 [4633]
250	15,657 [3520]
500	12,716 [2859]
1000	10,329 [2322]

### UT018

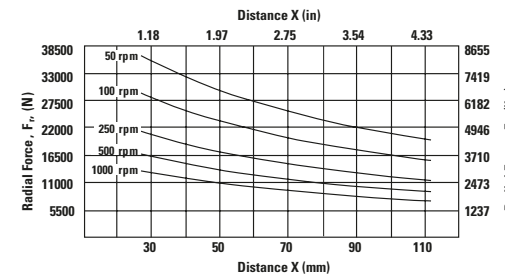
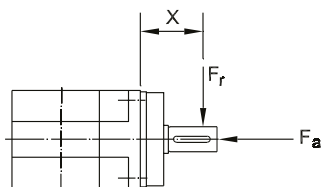

Speed rpm	Axial Load, $F_a$ N [lb <sub>f</sub> ]
50	34,538 [7765]
100	27,414 [6163]
250	20,197 [4541]
500	16,034 [3605]
1000	12,726 [2861]

### UT022

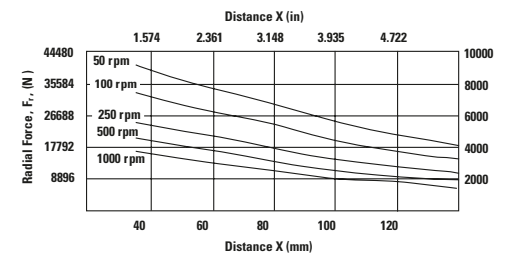
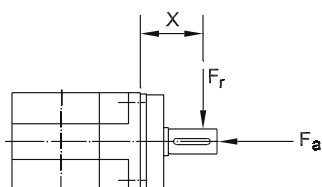

Speed rpm	Axial Load, $F_a$ N [lb <sub>f</sub> ]
50	32,351 [3655]
100	26,277 [2969]
250	19,962 [2256]
500	16,214 [1832]

These graphs display the allowable radial load at a given distance (X) from the mounting surface based on an  $L_{10}$  life of 10,000 hours for the mean output speed  $n_{mout}$ , as described on page 9.

**TRUE™ Planetary Gearheads**

